

Slatted Concrete Floor Catalogue

2016



Stallprofi

Comfort and Precision

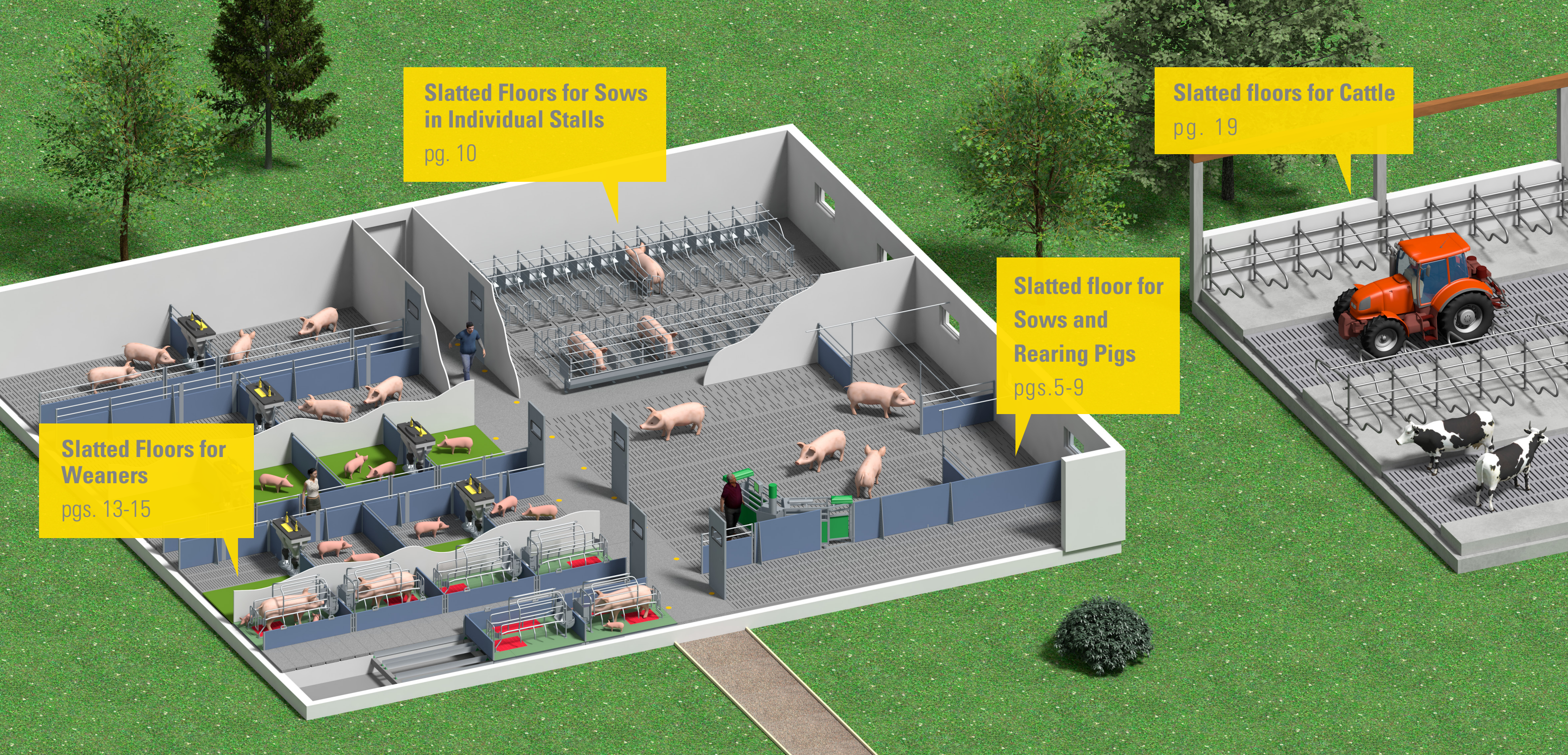

Slatted Floors for Weaners
pgs. 13-15

Slatted Floors for Sows in Individual Stalls
pg. 10

Slatted floor for Sows and Rearing Pigs
pgs.5-9

Slatted floors for Cattle
pg. 19

Contents

4 Slatted Floors for Pigs

- 5 FS slatted floor for sows and rearing pigs
- 6 FS-EC50 slatted floor for sows and rearing pigs (last 50 cm unslatted)
- 7 FS-EC100 slatted floor for sows and rearing pigs (last 100 cm unslatted)
- 8 FS RLX partially slatted floor for sows and rearing pigs
- 9 S-EX slatted floor for sows with dung chute
- 10 S-ID slatted floor for sows in individual stalls
- 11 FL and FL-O seamless floor boards for corridors

12 Slatted Floors for Weaners

- 13 13 PL slatted floors for weaners
- 14 PL-EC40 slatted floors for weaners (last 40 cm unslatted)
- 15 PL-EC80 slatted floors for weaners (last 80 cm unslatted)
- 16 12/18 bridges for slatted floors for pigs

17 Accessories for Slatted Floors for Pigs

- 17 Bunding slab for slatted floors for pigs
- 17 Crete TF anti-corrosion coating for slatted floors for pigs
- 17 Rubber strip bedding for concrete slatted floors

18 Slatted Floors for Cattle

- 19 CW and CW-P slatted floors for dairy cows and rearing cattle

20 Guaranteed Quality from Production to Installation

- 21 Manufacturing process
- 22 Quality control
- 22 Shipping and packaging
- 23 Installation



Slatted Floors for Pigs

DIN EN 12737

FS slatted floor for sows and rearing pigs

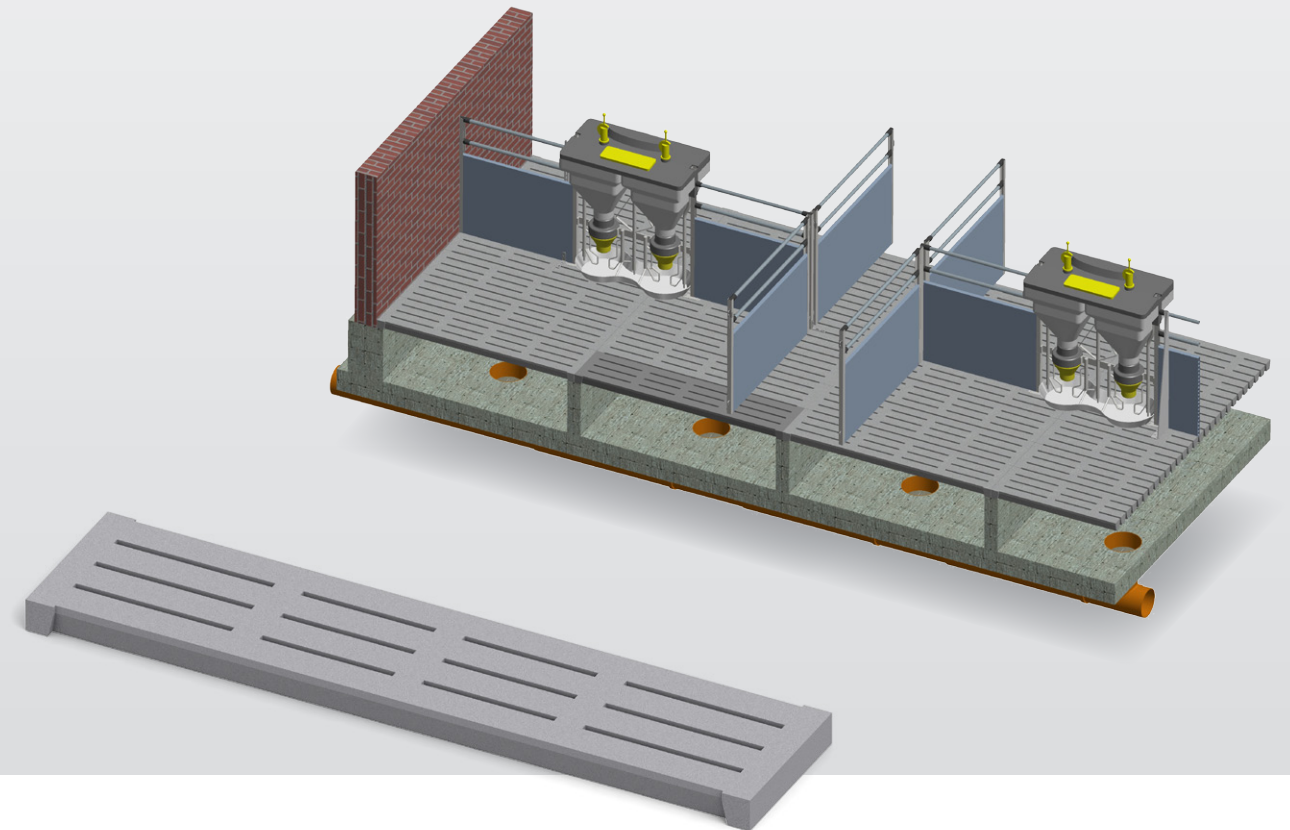

Our high quality floors with 17 mm slats are perfect for both fattening farms and group housing. The floors have a slightly
 -coarse surface to prevent slipping, injuries and stress.
 -Deburring on the edges ensures the safety of your valuable livestock.

This is our best-selling model. We recommend it for use in the animals' activity and dung areas. The floor's ridge shape and smooth inner surfaces make it self-cleaning, which is beneficial for the stable's internal environment.

Slat size	17 mm
Walking surface	83 mm
Cross-bridge	70 mm
Grid width	400 mm
Load bearing capacity	250 kg of live animal weight

SKU	Length	Height	Weight
06-012-40070	70 cm	7 cm	41.00 kg
06-012-40080	80 cm	7 cm	46.25 kg
06-012-40090	90 cm	7 cm	52.00 kg
06-012-40100	100 cm	7 cm	57.00 kg
06-012-40110	110 cm	7 cm	62.10 kg
06-012-40120	120 cm	7 cm	69.00 kg
06-012-40130	130 cm	7 cm	74.00 kg
06-012-40140	140 cm	7 cm	80.00 kg
06-012-40150	150 cm	7 cm	84.50 kg
06-012-40160	160 cm	8 cm	90.00 kg
06-012-40170	170 cm	8 cm	95.00 kg
06-012-40180	180 cm	8 cm	100.25 kg
06-012-40190	190 cm	8 cm	105.50 kg
06-012-40200	200 cm	8 cm	112.00 kg
06-012-40210	210 cm	8 cm	117.00 kg
06-012-40220	220 cm	8 cm	122.00 kg
06-012-40230	230 cm	8 cm	128.00 kg
06-012-40240	240 cm	8 cm	134.00 kg
06-012-40250	250 cm	8 cm	139.00 kg

FS-EC50 slatted floor for sows and rearing pigs (last 50 cm unslatted)

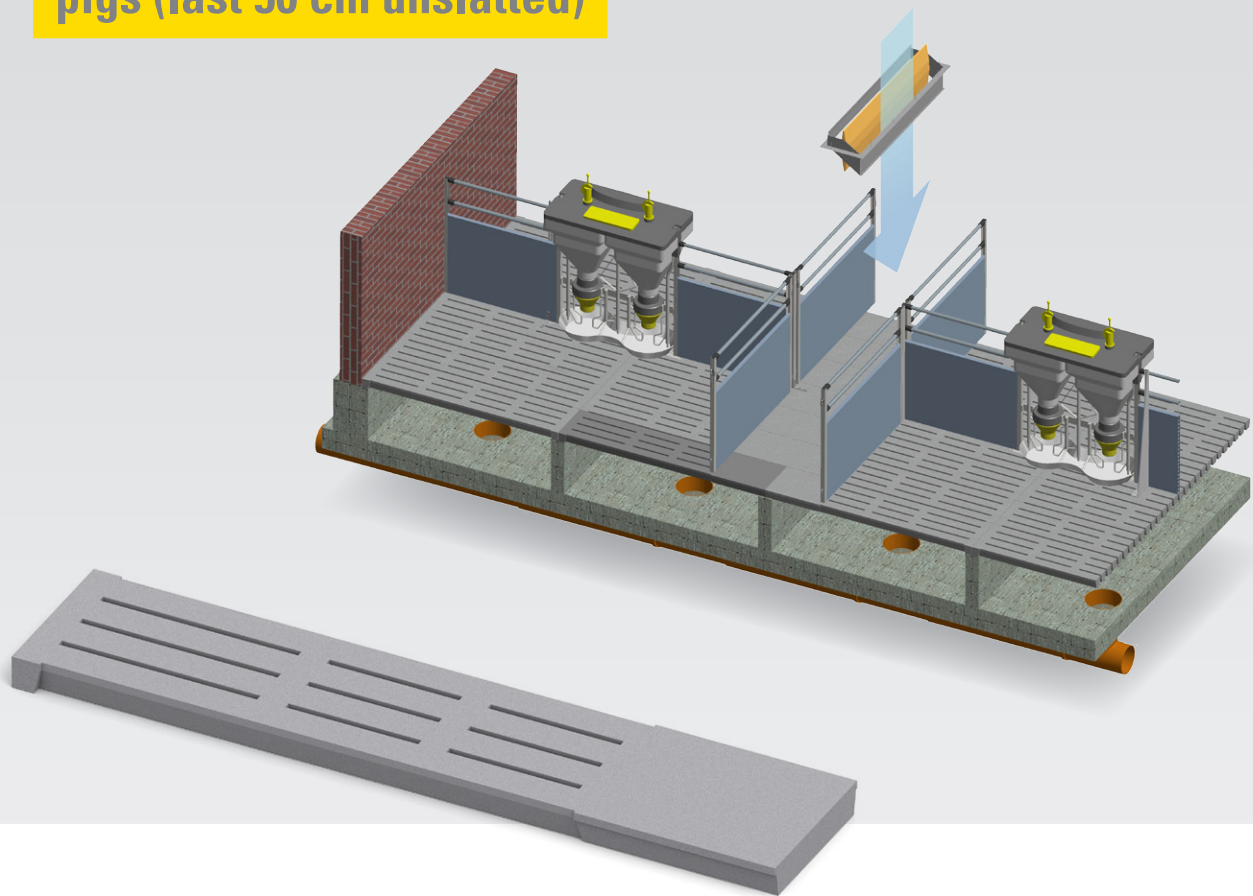

For corridor ventilation in rearing and weaning stalls, fully enclosed flooring is a basic requirement for the passages. The floor grids fit together seamlessly, preventing airflow from reaching the lagoon.

Enclosed area	50 cm
Slat size	17 mm
Walking surface	83 mm
Cross bridge	70 mm
Grid width	400 mm
Grid height	80 mm
Load bearing capacity	250 kg of animal weight

SKU	Length	Weight
54358	160 cm	91.79 kg
54359	170 cm	97.01 kg
54360	180 cm	103.50 kg
54361	190 cm	102.23 kg
54362	200 cm	113.52 kg
54363	210 cm	118.73 kg
54364	220 cm	123.95 kg
54365	230 cm	129.25 kg
54366	240 cm	135.23 kg
54367	250 cm	140.45 kg

FS-EC100 slatted floor for sows and rearing pigs (last 100 cm unslatted)

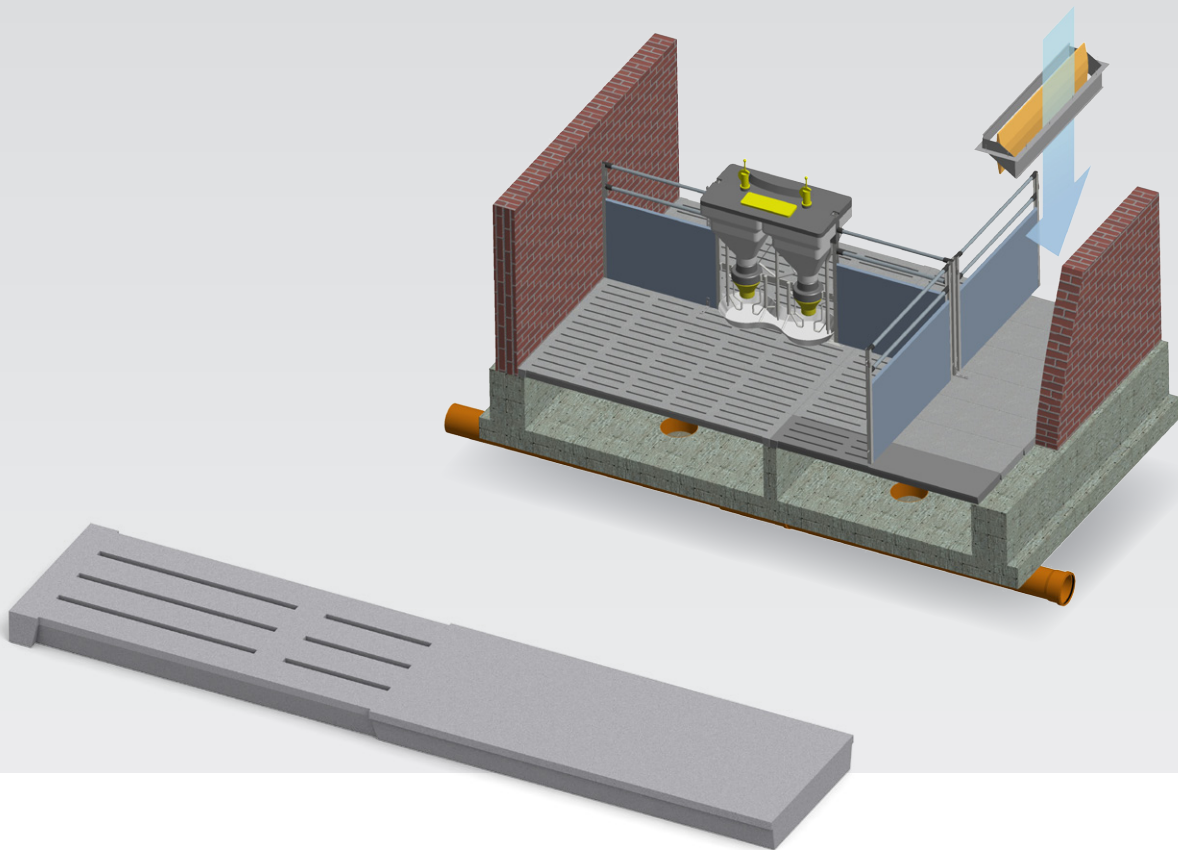

With an unslatted area of 100 cm at the end, this slatted floor was developed for use with corridor ventilation and hutches on one side only. The seamless fit prevents airflow from reaching the lagoon.

Enclosed area	100 cm
Slat size	17 mm
Walking surface	83 mm
Cross bridge	70 mm
Grid width	400 mm
Grid height	80 mm
Load bearing capacity	250 kg of animal weight

SKU	Length	Weight
54368	160 cm	93.79 kg
54369	170 cm	99.02 kg
54370	180 cm	104.23 kg
54371	190 cm	109.45 kg
54372	200 cm	115.51 kg
54373	210 cm	120.73 kg
54374	220 cm	125.95 kg
54375	230 cm	131.17 kg
54376	240 cm	137.23 kg
54377	250 cm	142.45 kg

FS RLX partially slatted floor for sows and rearing pigs

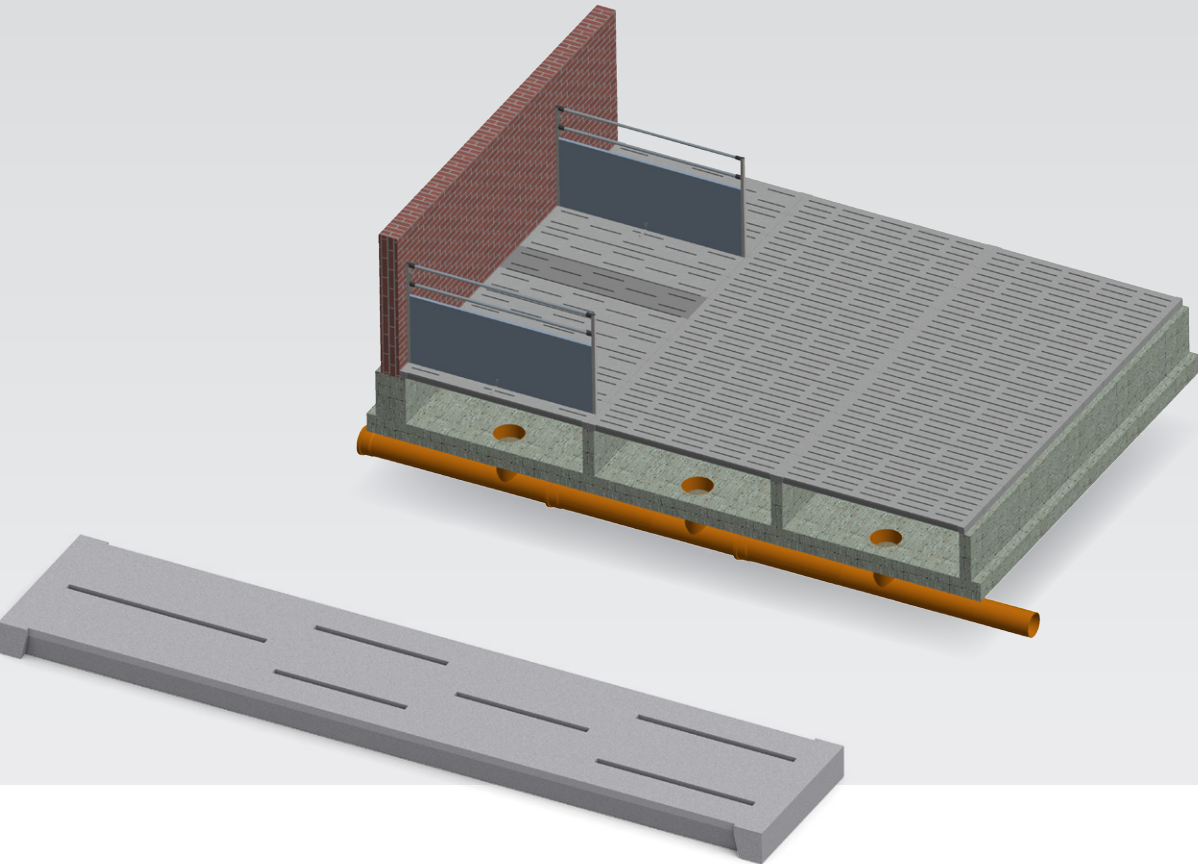

This model is recommended for covering the resting areas in group housing setups. The slat-to-flush-surface ratio is in line with regulations for both weaners and sows.

Slat size	17 mm
Walking surface	83/183 mm
Cross bridge	70 mm
Grid width	400 mm
Grid height	80 mm
Load bearing capacity	250 kg of animal weight

SKU	Length	Weight
54260	160 cm	91.71 kg
54261	170 cm	97.08 kg
52920	180 cm	102.37 kg
52921	190 cm	107.75 kg
54262	200 cm	113.70 kg
54263	210 cm	118.97 kg
54264	220 cm	124.29 kg
54265	230 cm	129.59 kg
54266	240 cm	135.89 kg
54267	250 cm	141.27 kg

S-EX slatted floor for sows with dung chute

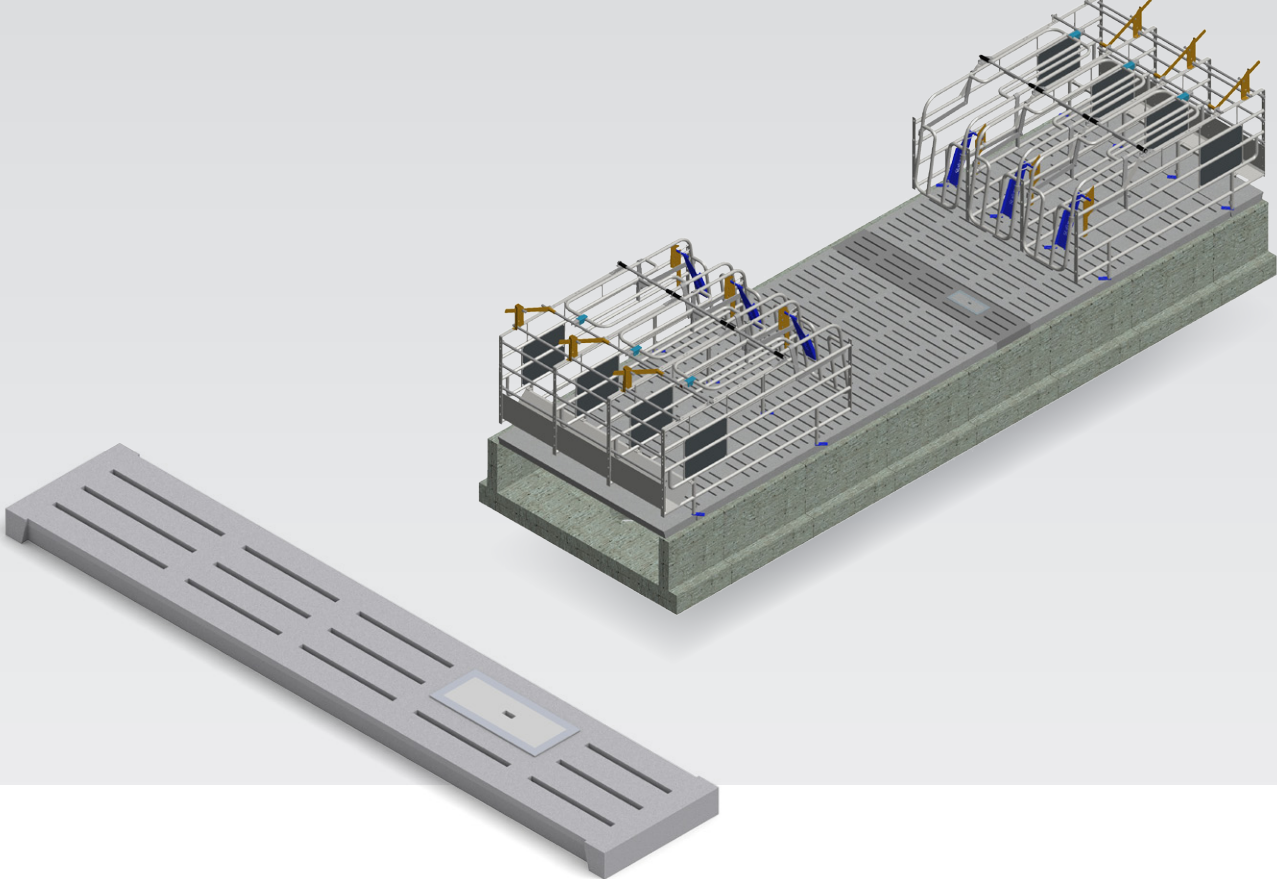

As group housing offers large living spaces for animals, dung compression is not as intensive as in rearing farms. The dung chute with its hot-dip galvanized lid reduces water consumption during dung removal. Disposal points are recommended for every 30m².

Slat size	17 mm
Walking surface	83 mm
Cross bridge	70 mm
Chute width	117 mm
Chute length	300 mm
Grid width	400 mm
Grid length	700-2500 mm
Grid height	80 mm
Load bearing capacity	250 kg of animal weight

SKU	Length	Weight
52263	160 cm	85.85 kg
54268	170 cm	91.07 kg
54269	180 cm	96.29 kg
54270	190 cm	101.51 kg
54271	200 cm	107.56 kg
54272	210 cm	112.79 kg
54273	220 cm	118.00 kg
54274	230 cm	123.22 kg
54275	240 cm	129.28 kg
54276	250 cm	134.50 kg
52267	33x10.6 cm plug for the floor's dung chute	

S-ID slatted floor for sows

in individual stalls

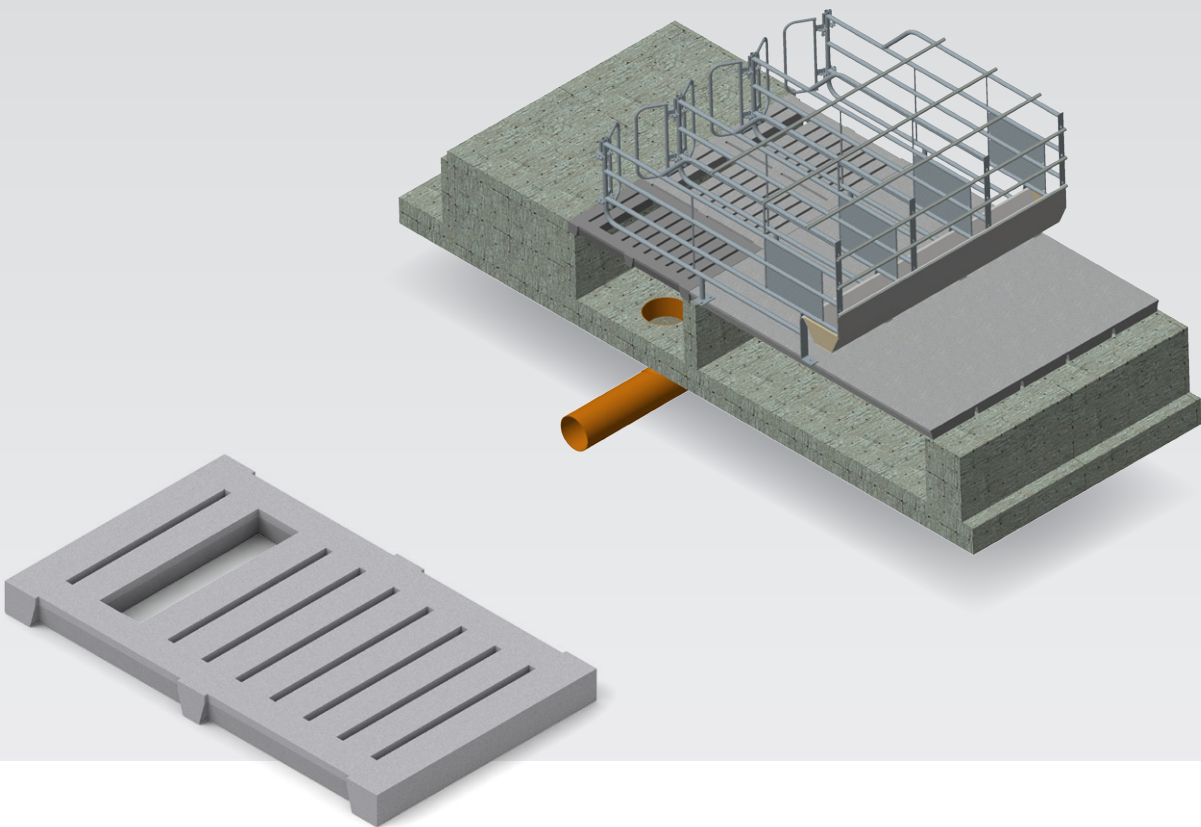

The ID product focuses on hygiene, eliminating recontamination via the genitals. The majority of sows defecate into the 100 mm opening. Any remaining dung can be disposed of in the opening using a scraper.

The 20 mm cross-slats provide an enhanced grip for sows along with safe disposal of liquids.

Slat size	20 mm
Walking surface	80 mm
Chute width	100 mm
Grid width	650 mm
Chute length	800 mm
Grid height	80 mm
Load bearing capacity	250 kg of animal weight

SKU	Length	Width	Weight
54277	100 cm	65 cm	94.25 kg
54278	110 cm	65 cm	104.00 kg
54279	120 cm	65 cm	113.50 kg

FL and FL-O seamless floor boards for corridors

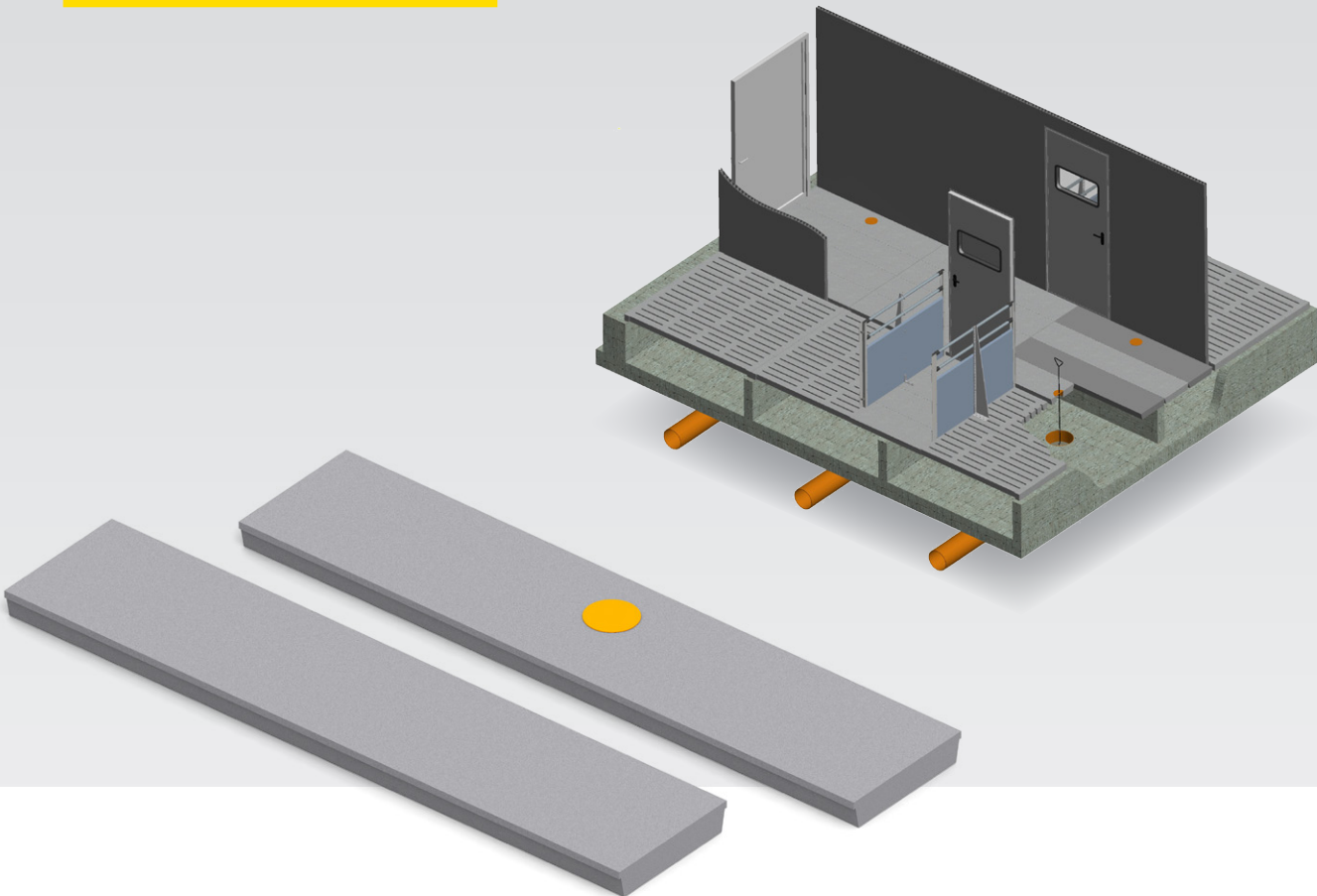

We developed our seamless floor board product line for the central corridors of structures with a block layout. The product significantly reduces the requirement for a concrete foundation.

Dung plugs below the central corridor can be extracted via a hatch in the FL-O model.

Board width	400 mm
Board height	80 mm
Load bearing capacity	250 kg of live animal weight

FL floor board

SKU	Length	Weight
54312	160 cm	94.84 kg
54313	170 cm	100.44 kg
53162	180 cm	106.04 kg
54314	190 cm	111.63 kg
54315	200 cm	117.91 kg
54316	210 cm	123.47 kg
54317	220 cm	129.09 kg
54318	230 cm	134.69 kg
54319	240 cm	140.97 kg
54320	250 cm	146.56 kg

FL-O floor board with d=125 mm hatch

SKU	Length	Weight
54424	160 cm	95.39 kg
54425	170 cm	102.24 kg
54426	180 cm	109.10 kg
54427	190 cm	112.94 kg
54428	200 cm	119.13 kg
54429	210 cm	124.69 kg
54430	220 cm	130.32 kg
54431	230 cm	135.92 kg
54432	240 cm	143.90 kg
54433	250 cm	148.24 kg



Slatted Floors for Weaners

DIN EN 12737

PL slatted floor for weaners

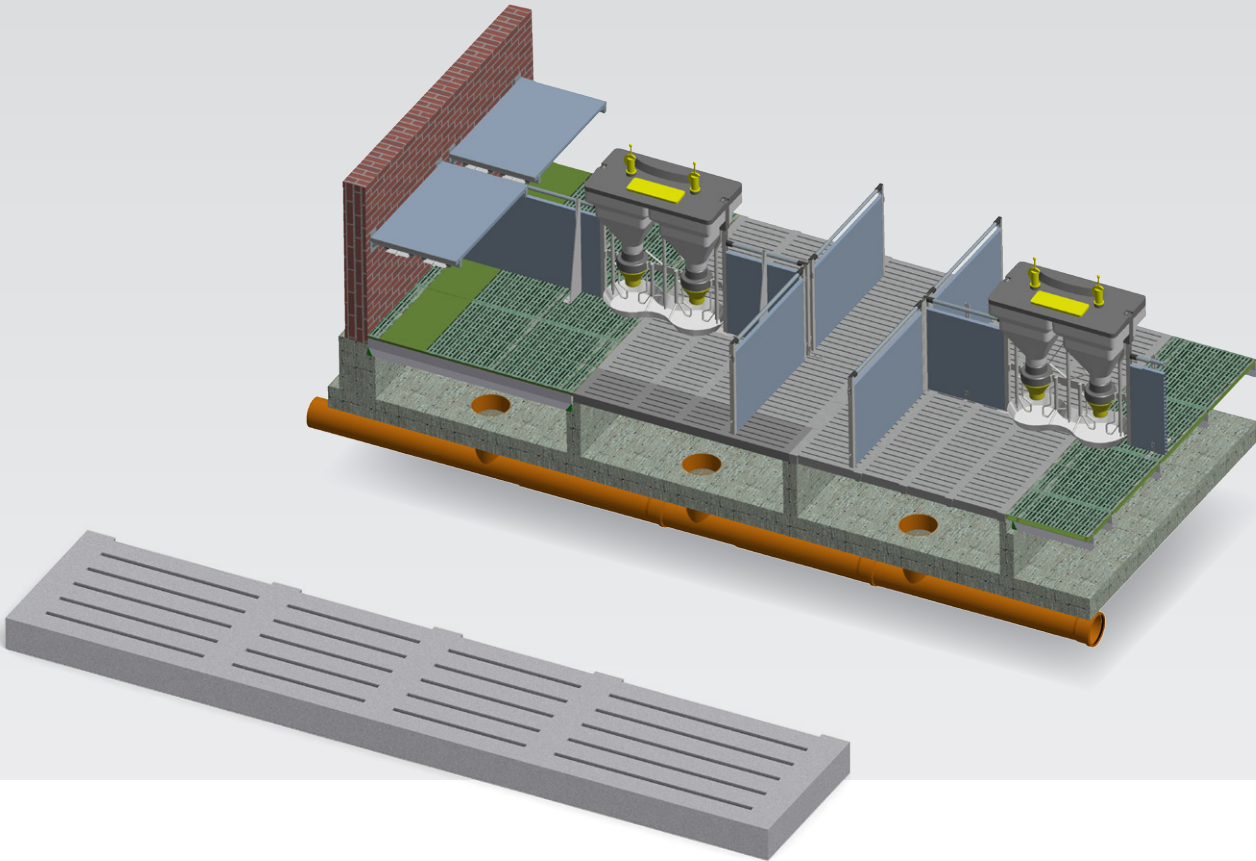

The combined surface of the weaner stalls features concrete slatted floors and plastic slatted flooring. This combination ensures proper hoof abrasion and seamless transition to concrete slatted floors.

Slat size	12 mm
Walking surface	53.5 mm
Cross bridge	70 mm
Grid width	400 mm
Grid height	80 mm
Load bearing capacity	45 kg of animal weight

SKU	Length	Weight
54472	80 cm	40.86 kg
54473	90 cm	45.15 kg
54474	100 cm	49.43 kg
54475	110 cm	53.72 kg
54476	120 cm	58.89 kg
54477	130 cm	63.18 kg
54478	140 cm	67.46 kg
54479	150 cm	71.75 kg
54480	160 cm	78.17 kg
54481	170 cm	82.55 kg
54482	180 cm	86.95 kg
54483	190 cm	91.33 kg
54484	200 cm	96.61 kg
54485	210 cm	100.96 kg
54486	220 cm	105.38 kg
54487	230 cm	109.78 kg
54488	240 cm	115.05 kg
54489	250 cm	119.44 kg

PL-EC40 slatted floor for weaners
(last 40 cm unslatted)

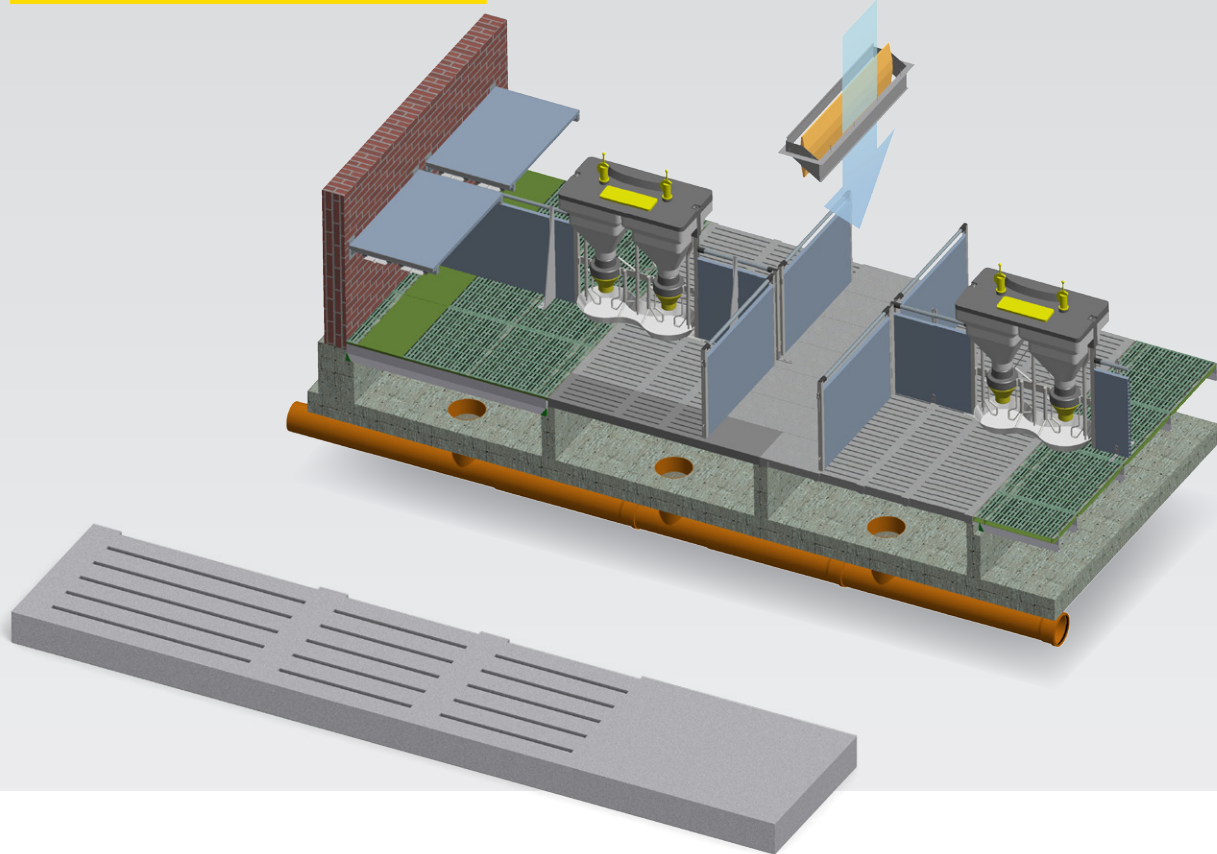

In case of corridor ventilation for weaning stalls, fully enclosed flooring is a basic requirement for the passages. The floor grids fit together seamlessly, preventing airflow from reaching the lagoon.

Enclosed area	40 cm
Slat size	12 mm
Walking surface	53,5 mm
Cross bridge	70 mm
Grid width	400 mm
Grid height	80 mm
Load bearing capacity	45 kg of animal weight

SKU	Length	Weight
54452	160 cm	79.33 kg
54453	170 cm	83.72 kg
54454	180 cm	88.11 kg
54455	190 cm	92.61 kg
54456	200 cm	97.78 kg
54457	210 cm	102.16 kg
54458	220 cm	106.55 kg
54459	230 cm	111.05 kg
54460	240 cm	116.21 kg
54461	250 cm	120.60 kg

PL-EC80 slatted floor for weaners
(last 80 cm unslatted)

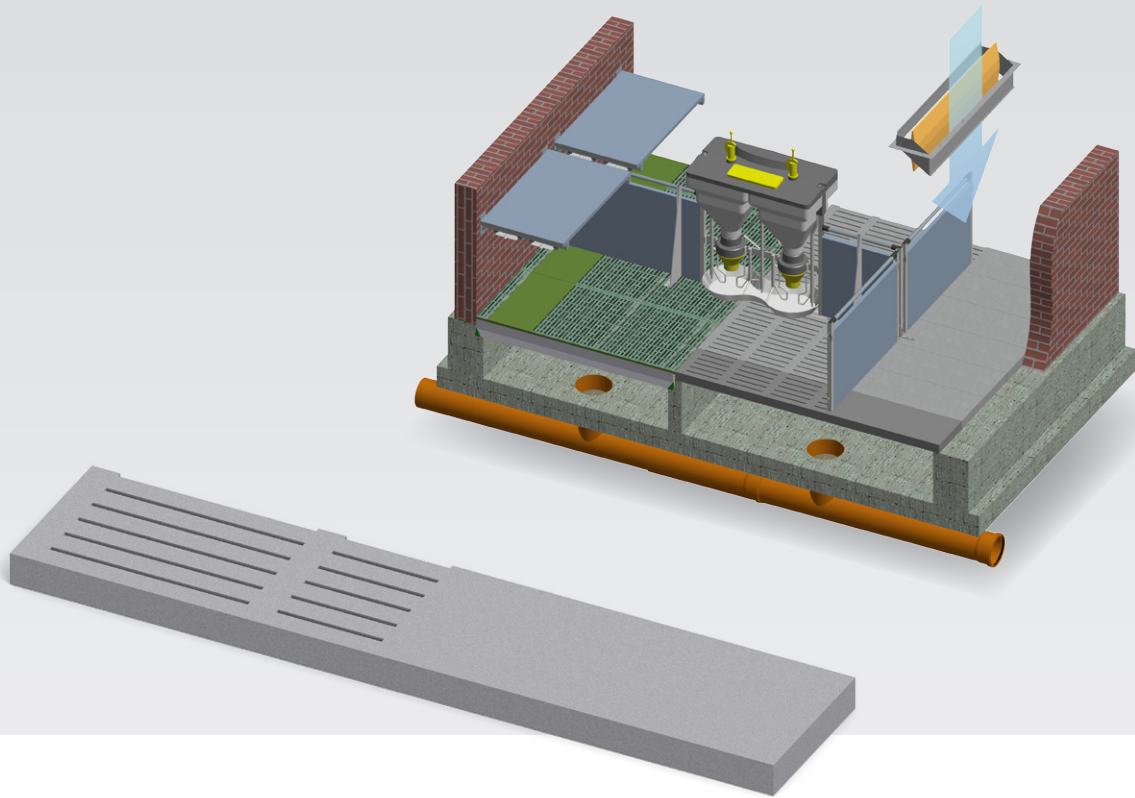

With an unslatted area of 80 cm at the end, this slatted floor was developed for use with corridor ventilation and asymmetrical hutch layouts. The seamless fit prevents airflow from reaching the lagoon.

Enclosed area	80 cm
Slat size	12 mm
Walking surface	53,5 mm
Cross bridge'	70 mm
Grid width	400 mm
Grid height	80 mm
Load bearing capacity	45 kg of animal weight

SKU	Length	Weight
54462	160 cm	80.73 kg
54463	170 cm	85.12 kg
54464	180 cm	89.51 kg
54465	190 cm	93.89 kg
54466	200 cm	99.16 kg
54467	210 cm	103.55 kg
54468	220 cm	107.94 kg
54469	230 cm	112.33 kg
54470	240 cm	117.61 kg
54471	250 cm	121.99 kg

12/18 bridge for slatted floors for pigs

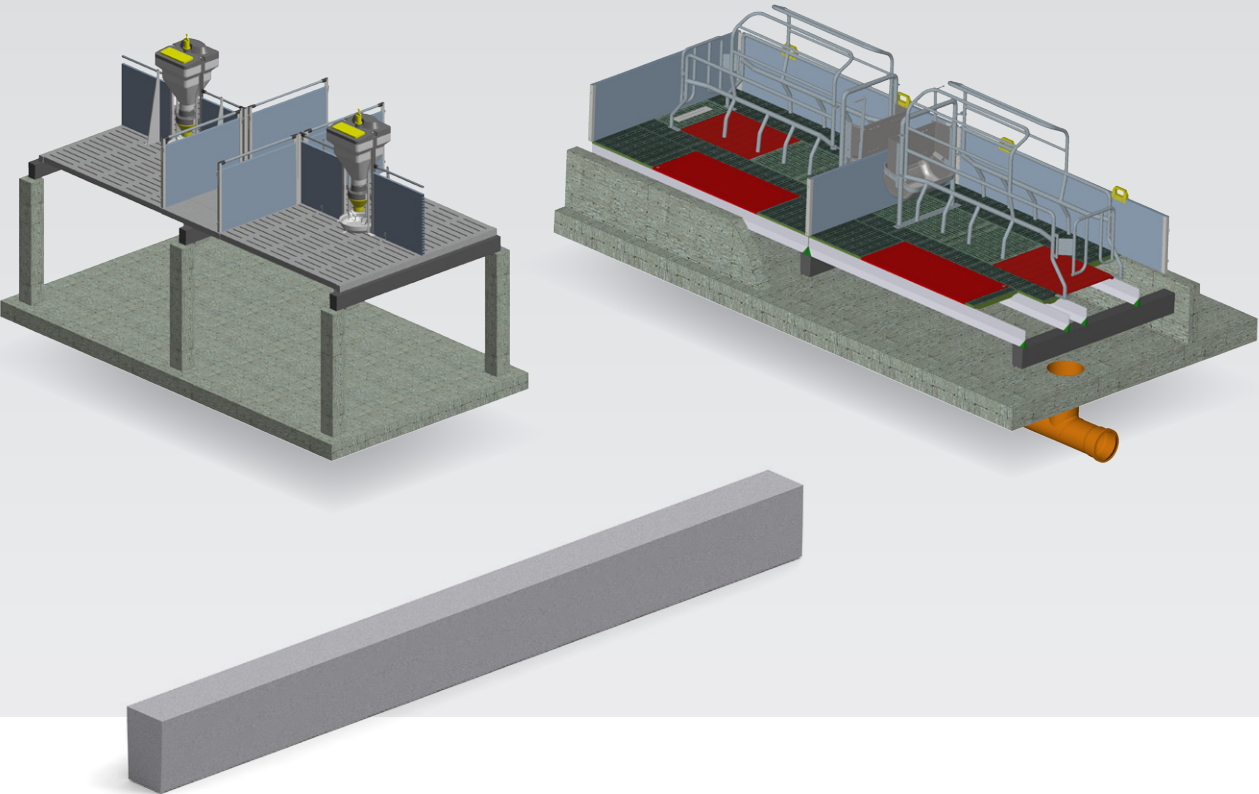

Our bridges significantly reduce the requirement for a concrete foundation. These models can be integrated into lagoon designs for pigs of all ages.

Upper width	120 mm
Lower width	110 mm
Height	180 mm
Base area	150 mm

SKU	Length	Weight
54321	100 cm	50.58 kg
54322	110 cm	55.23 kg
54323	120 cm	59.89 kg
54324	130 cm	64.55 kg
54325	140 cm	69.21 kg
54326	150 cm	73.86 kg
54327	160 cm	78.52 kg
54328	170 cm	83.18 kg
54329	180 cm	87.84 kg
54330	190 cm	92.49 kg
54331	200 cm	97.15 kg
54332	210 cm	101.81 kg
54333	220 cm	106.47 kg
54334	230 cm	111.12 kg
54335	240 cm	115.78 kg
54336	250 cm	120.44 kg

Bunding slab for slatted floors for pigs

No-slip plastic bunding slabs protect slatted concrete floors from the corrosive effects of feed pushed out of the feeder.– They also result in significantly decreased feed waste. The slabs are fastened to the floor using stainless steel connectors.

SKU	Size
54512	122 x 122 x 0.8 cm
54513	164 x 122 x 1 cm

Crete TF anti-corrosion coating for slatted floors for pigs

The three-component polyurethane resin is resistant to organic and inorganic acids and alkaline compounds. In addition to the walking surface, coating should also be applied to the insides of the slats.

SKU	55597
Color	gray
Packaging	5 kg
Coverage	400g/m²
Application	Between 5 and 20°C
Walkable	in 24 hours
Full bonding	3 days

Rubber strip bedding for concrete slatted floors

Unevenness in the foundation may result in unstable floors and consequently, stress. Rubber bedding strips even out the differences, eliminate the bumping sound and the feeling of instability.

SKU	Width
55594	80 mm
55595	150 mm
Color	black
Length	20m
Width (single)	80 mm
Width (double)	150 mm
Thickness	3 mm

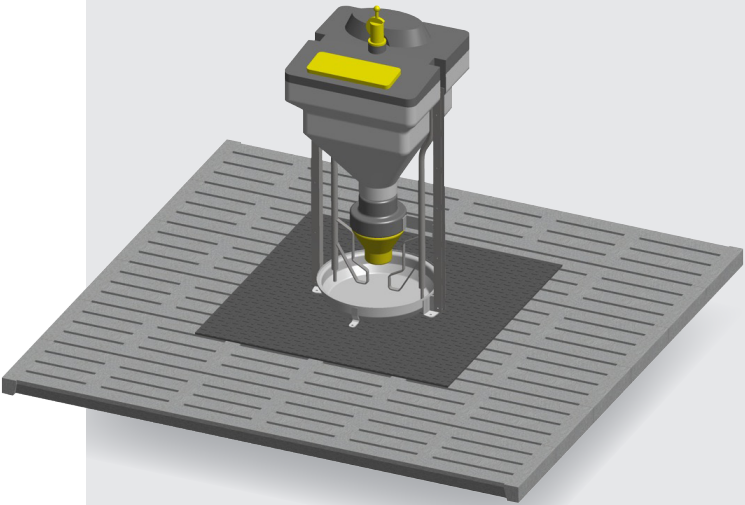



Slatted Floors for Cows

DIN EN 12737

CW és CW-P slatted floors for dairy cows and rearing cattle

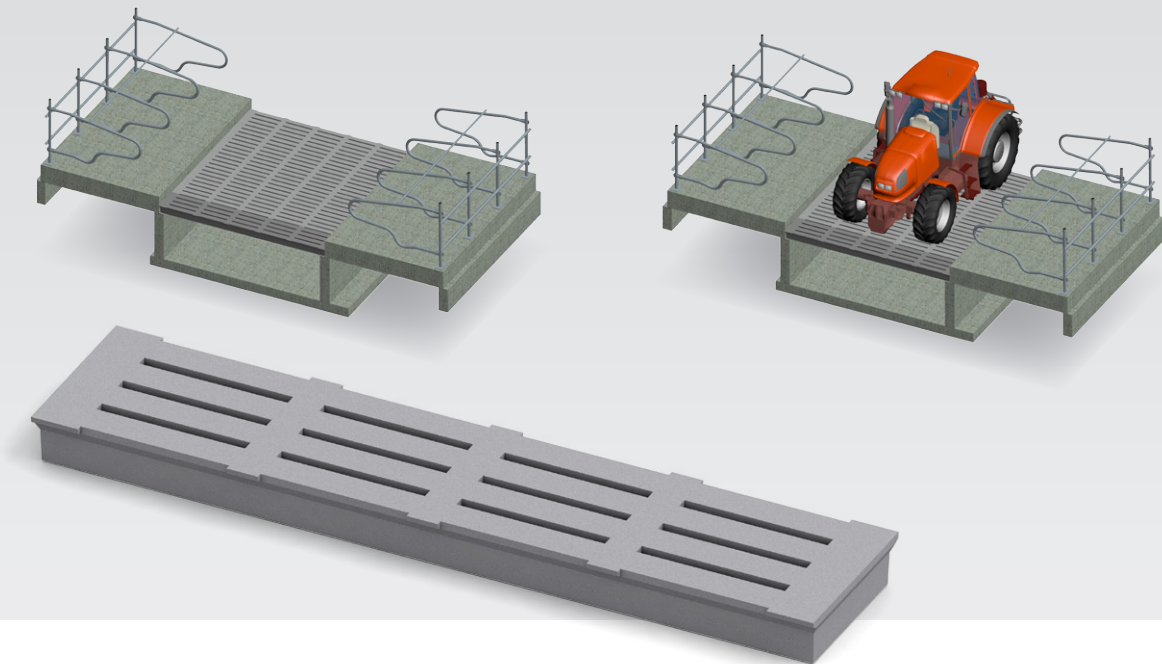

With its non-slip surface and large dung throughflow capacity, this product line is a favorite in cattle farming.

The P series is designed for 5 tons of axial pressure. The product was developed for customers who use tractors for dung displacement and hay blowing for boxes, as well as for extracting sick animals.

Slat size	35 mm
Walking surface	102,5 mm
Cross-bridge	100 mm
Grid width	550 mm
Grid length	2000-3500 mm
Grid height	160 mm
Load bearing capacity (CW /CW P)	850 kg of cattle / 5 t axial stress

CW slatted floors for dairy cows and rearing cattle

SKU	Length	Weight
06-022-55200	200 cm	314.50 kg
06-022-55210	210 cm	329.00 kg
06-022-55220	220 cm	343.50 kg
06-022-55230	230 cm	358.00 kg
06-022-55240	240 cm	372.50 kg
06-022-55250	250 cm	392.00 kg
06-022-55260	260 cm	406.50 kg
06-022-55270	270 cm	420.90 kg
06-022-55280	280 cm	435.30 kg
06-022-55290	290 cm	450.00 kg
06-022-55300	300 cm	464.25 kg
06-022-55310	310 cm	484.00 kg
06-022-55320	320 cm	498.50 kg
05-022-55330	330 cm	513.00 kg
06-022-55340	340 cm	527.25 kg
06-022-55350	350 cm	542.00 kg

CW-P slatted floors for dairy cows and rearing cattle

SKU	Length	Weight
54342	200 cm	324.50 kg
54343	210 cm	340.00 kg
54344	220 cm	354.50 kg
54345	230 cm	369.00 kg
54346	240 cm	384.00 kg
54347	250 cm	405.00 kg
54348	260 cm	419.50 kg
54349	270 cm	434.00 kg
54350	280 cm	449.00 kg
54351	290 cm	464.25 kg
54352	300 cm	479.00 kg
54353	310 cm	504.50 kg
54354	320 cm	519.50 kg
54355	330 cm	534.50 kg
54356	340 cm	549.20 kg
54357	350 cm	564.00 kg



Manufacturing Process

Our slatted floor plant's development was based on 30 years of experience in manufacturing concrete for transportation and concrete parts. Since 2012, we have been producing 250 slatted floor pieces each shift using two production lines. The quality of our products is unprecedented in Hungary, which is due to:

- categorized materials
- computerized mixture control
- German-made production lines, templates, and high-frequency vibrating tables
- and warping-free drier trays.

We are a family business that values its employees. This fact provides the initiative for constant development and improvement.



Guaranteed Quality
from Production to Installation



Quality Control

Nowadays, slatted floors are more than simple concrete products. To meet the high standards

- of the market, we check the slat sizes on all of our products,
- and employ regular stress test in a laboratory.

Every Stallprofi slatted floor batch has an ID number to assist failure analysis in case of any issues, thereby further improving the manufacturing process.

Shipping and Packaging

Slatted floors may suffer damage during transportation and shipping. We devote special attention to packaging and unloading support in order to supply perfect products. Edge protectors minimize the risk of dents while the unloading manual supports machinery operators in lifting and storage operations.



Installation

We offer support during installation to prevent issues and damage. Our custom designed hand cart is perfect for quickly moving and accurately positioning the floor parts. To order our installation services, please contact us or a Stallprofi retailer.

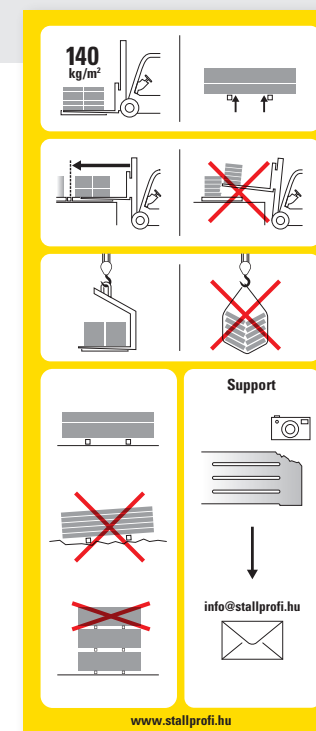

Stallprofi Magyarország Kft.

H2100 Gödöllő, Dózsa György út 13.

Telefon: (+36) 28 514 485

E-mail: info@stallprofi.hu

www.stallprofi.hu

Retailers

